

MODE SELECT TABULATION		
MODE	MODE	MODE
0V	0V	MID RANGE
+VS	+VS	HIGH RANGE
+VS	0V	CREEP RANGE
+VS	+VS	CREEP RANGE

SOLID STATE AUX OUTPUTS
SEE FUNCTIONAL DRAWING SUPPLY - 20V
OUTPUT CURRENT = 2.5A MAX

PCD CONNECTOR
HEADER #ELFH1225S1
MATES WITH MANY
PCD & PHOENIX PLUG
STYLES i.e. #ELFP12210
PLUG SOLD SEPARATELY

MOUNTING HOLE
#6 CLEARANCE
4PL

LEDS ILLUMINATE TO
INDICATE OUTPUT
A OR B OPERATION
SEE NOTES

PROGRAMMING PORT
INDICATES VALVE
CURRENT OR
PROGRAMMING
PARAMETER

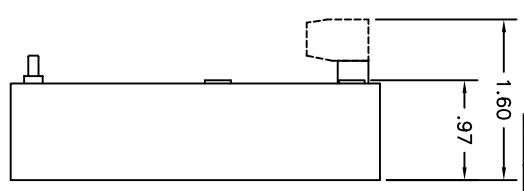

REV	DESCRIPTION	DATE
-	ORIGINAL RELEASE	05-01-01
A	MODEL NUMBER W/S: M519	04-02-02
B	CORRECTED CONNECTOR ORIENTATION ECR #1763	07-19-02
C	MODEL # WAS: M519-01	01-23-06
JCH	IMPROVED OPERATING TEMPERATURE CORRECTED DIMENSIONS	11-30-11
D	ADDED THE M519-LCF	05-13-11
E	ADDED THE M519-NL OPTION	09-25-17
F	ADDED HEAT SINK	02-18-21
G	ADDED HEAT SINK	02-18-21
H	ADDED HEAT SINK	04-01-21
W/C	ECR #2530	
M/C	ECR #2530	

NOTES: 1) VOLTAGE SUPPLY MAY BE +10 TO 30VDC FROM VEHICLE BATTERY OR REGULATED POWER SUPPLY.
2) FREQUENCY IS PROGRAMMABLE FROM 40 TO 400HZ.
3) COMMON AUX IS PROGRAMMABLE FROM 5 TO 100% OF SPECIFIED RANGE. MAXIMUM CURRENT CAPABILITY IS 2.5 AMPS.
4) AUX A & AUX B SWITCH ON V SUPPLY SIMULTANEOUS WITH PROPORTIONAL OUTPUTS. MAXIMUM CURRENT CAPABILITY IS 2.5 AMPS.
5) PWM FULL OUTPUT CAN BE SCALED ALONG THE CONTROL LEVER DISPLACEMENT BY ADJUSTING "MAX SIGNAL" FROM 100% TO DEADBAND i.e. WITH MAX SIGNAL SET TO 60%, FULL OUTPUT WILL OCCUR AT 60% CONTROL LEVER POSITION.
6) DEADBAND IS PROGRAMMABLE FROM 10 TO 50%.
7) M519-LCF (Low Current with Filter— current leaking protection) IS CONFIGURED FOR MCV116G42XX DANFOSS VALVE 15.5&19 OHM COIL OUTPUT CURRENT: 15mA-85mA
8) M519-NL HAS A NON-LINEAR OUTPUT.

AUX B	AUX A	COMMON AUX (PROGRAMMABLE)	PWM B	PWM A
OFF	OFF	OFF	OFF	OFF
20% B	20% A	20% A	20% A	20% A
90% B	90% A	90% A	90% A	90% A
100% B	100% A	100% A	100% A	100% A

* EXAMPLE FOR ILLUSTRATION ONLY, OUTPUT IS FULLY PROGRAMMABLE.

FUNCTION DIAGRAM

WARNING: P-D Controls, Inc. products are intended for general purpose use only. They are NOT safety devices. Do not use in applications where failure could result in injury or death. For more information, contact your distributor or P-D Controls, Inc. directly.

P-D Controls, Inc.
95 Danforth Rd.
Bristol, CT 06010
PHONE: (860) 583-8994
FAX: (860) 583-6011

DATE: 05-01-01